



## PRODUCT NAME: Revolver Whiteboard

### PRODUCT SHORT DESCRIPTION:

Practical mobile revolving double sided whiteboard

#### FEATURES AND BENEFITS:

- Economical mobile solution
- Robust stand mounted on four locking castors
- Available in three choices of surface
- Non magnetic dryerase surface
- Magnetic coated steel or premium ceramic surface
- Repositionable metal pen tray

#### PHOTOGRAPHY AVAILABLE:

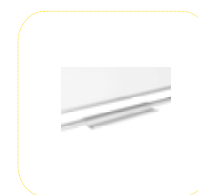
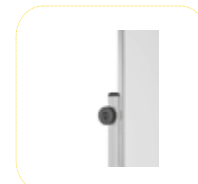

#### MARKETING COPY:

As all our Mobile Boards provide stable solutions for use in conference rooms and multifunctional spaces. Adding portability to our top-line boards we created versatile solutions that combine the best and most useful characteristics of our dryerase magnetic boards with the possibility of using a double faced surface to expedite presentations.

#### APPLICATION AND SALES PROPOSITION:

- Revolver Boards conveniently rotate allowing to show or hide pre-prepared information using our double-faced boards.
- Traction handle controls rotation for maximum comfort and versatility.
- The handy moveable tray enhances flexibility and customization of the structure.

#### TARGET MARKET:

CHANNEL: Office products wholesalers, office products stores, decoration products wholesalers, decoration stores and other retailers

END USERS: conference centers, hotels, companies and organizations in general

#### ADDITIONAL NOTES:

Other information supports: our official websites, Youtube®, Facebook®, catalogue and online catalogue, demo videos and more.

#### PROMOTIONAL TIPS:

No specific timing, thus we recommend the occasional promotion like product and offering of cleaning kits, magnetic planning kits or markers

### RANGING TABLE:

Frame/Colour:	Surface/Colour:	Product Size:	Packed mm	N.W. kg	G.W. kg	Reference:	RRP:
Grey aluminium	White ceramic steel	900x1200	1890x95x65	28	30,8	QR1004	---
Grey aluminium	White ceramic steel	1200x900	1890x95x65	28	30,8	QR0204	---
Grey aluminium	White ceramic steel	1200x1200	1890x1260x65	33	36	QR0304	---
Grey aluminium	White ceramic steel	1500x1000	1890x1260x65	33	36	QR0604	---
Grey aluminium	White ceramic steel	1500x1200	1890x1260x65	38	41,5	QR0404	---
Grey aluminium	White ceramic steel	1800x1200	2000x1260x65	42,5	45	QR0504	---



**RANGING TABLE:**

Frame/Colour:	Surface/Colour:	Product Size:	Packed mm	N.W. kg	G.W. kg	Reference:	RRP:
Grey aluminium	White ceramic steel	2000x1000	2220x1060x65	42,5	45	QR0704	---
Grey aluminium	White magnetic	900x1200	1890x95x65	25,00	28,30	QR1003	---
Grey aluminium	White magnetic	1200x900	1890x95x65	25,00	28,30	QR0203	---
Grey aluminium	White magnetic	1200x1200	1890x1260x65	29,00	32,50	QR0303	---
Grey aluminium	White magnetic	1500x1000	1890x1260x65	29,00	32,50	QR0603	---
Grey aluminium	White magnetic	1500x1200	1890x1260x65	33,00	37,00	QR0403	---
Grey aluminium	White magnetic	1800x1200	2000x1260x65	36,50	40,50	QR0503	---
Grey aluminium	White magnetic	2000x1000	2220x1060x65	34,50	38,50	QR0703	---
Grey aluminium	White non-magnetic	900x1200	1890x95x65	21,10	24,10	QR1001	---
Grey aluminium	White non-magnetic	1200x900	1890x95x65	21,10	24,10	QR0201	---
Grey aluminium	White non-magnetic	1200x1200	1890x1260x65	23,80	27,20	QR0301	---
Grey aluminium	White non-magnetic	1500x1000	1890x1260x65	23,80	27,20	QR0601	---
Grey aluminium	White non-magnetic	1500x1200	1890x1260x65	26,60	31,00	QR0401	---
Grey aluminium	White non-magnetic	1800x1200	2000x1260x65	29,50	34,00	QR0501	---
Grey aluminium	White non-magnetic	2000x1000	2220x1060x65	29,00	33,00	QR0701	---

**TECHNICAL DETAILS****COMPOSITION:**

- Aluminium frame
- Wooden based core with ceramic steel surface, magnetic or white melamine on chipboard
- Wide pen tray included
- Traction handle
- Steel powdercoated structure
- 4 plastic locking castors

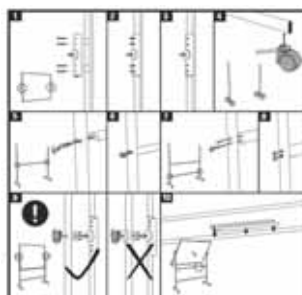
**ASSEMBLY OVERVIEW:****CERTIFICATION AND LEGISLATION:**

n/a

**ILLUSTRATION:**

**SUGGESTED ADVERT:****Revolver Whiteboard****Practical mobile revolving double sided whiteboard**

- Economical mobile solution
- Robust stand mounted on four locking castors
- Available in three choices of surface
- Non magnetic dryerase surface
- Magnetic coated steel or premium ceramic surface
- Repositionable metal pen tray

**WITHIN FAMILY:**

n/a

**QR CODE:**

Revision: 00/ 12-07-2013